



REFR SPORTS

Creating Your Account as an Official

The screenshot shows the 'Register' page on the REFR SPORTS website. The form is titled 'Create your account' and includes the following fields and elements:

- TYPE OF ACCOUNT:** A dropdown menu with 'Referee' selected. An annotation 'Select Referee' with an arrow points to this field.
- DATE OF BIRTH:** A text field containing '06/13/2000'.
- FIRST NAME:** A text field containing 'Huck'.
- LAST NAME:** A text field containing 'Sorock'.
- EMAIL:** A text field containing 'referee@refrsports.com'.
- PASSWORD:** A text field with masked characters and a strength indicator icon.
- REPEAT PASSWORD:** A text field with masked characters and a strength indicator icon. An annotation 'Click Here' with an arrow points to the 'Create account' button.
- Log In:** A yellow button in the top right corner.
- Create account:** A yellow button at the bottom right of the form.
- Already have an account? Log In:** A link at the bottom left of the form.

At the bottom of the page, there is a footer with the following text: ©2023 Refr Sports, Privacy Policy, and Terms and Conditions.

- After you select to create an account, be sure that your 'Type of Account' is flipped onto 'Referee'.
- Fill out all of the fields and click "Create Account".

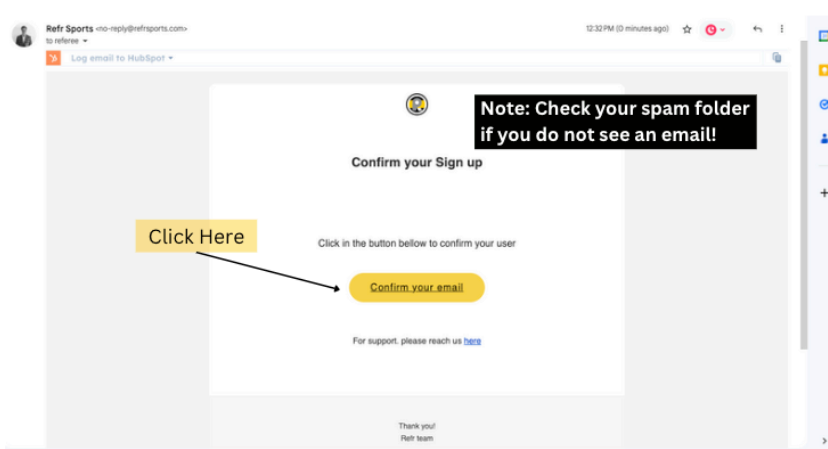

- You'll be asked to confirm your email address via and be sure to check your spam folder if you're not seeing the confirmation email in your inbox!

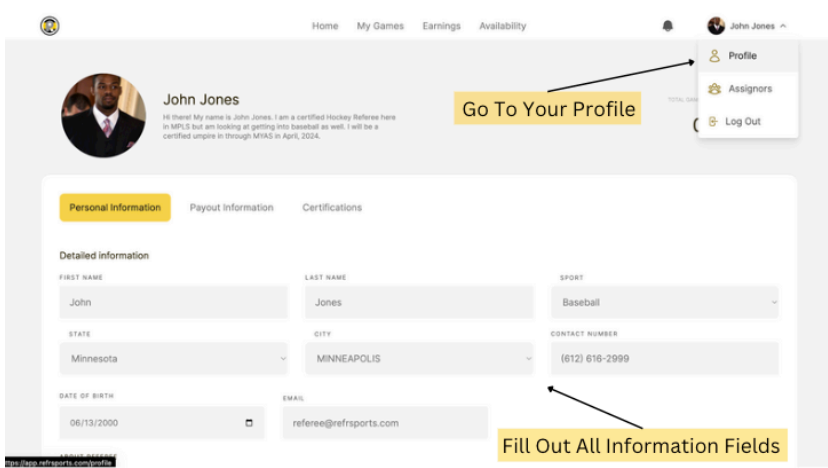

- Your next step will be to locate your profile and fill out the remaining information fields.

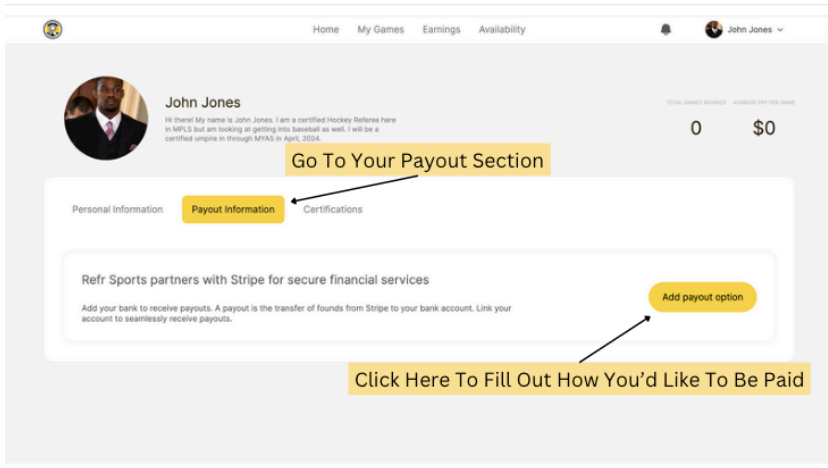

- From there, you'll click over to the **Payment Information** section.
- Click to add a payout option and this is where you'll receive compensation for the games that you work.

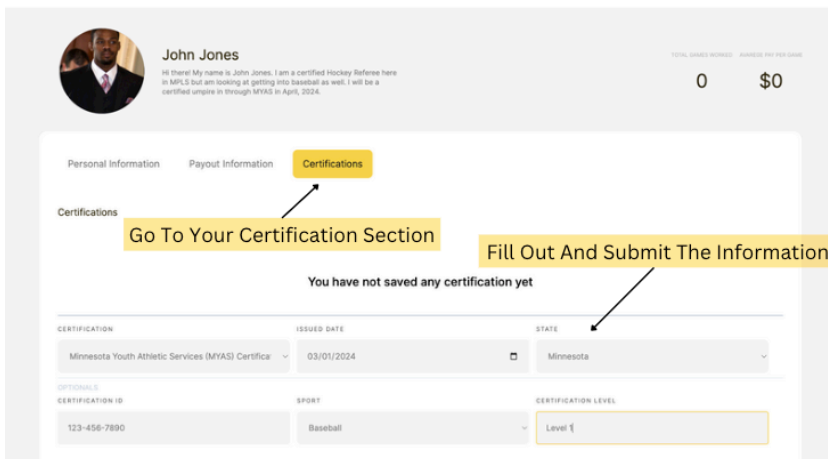

- Click over to the **Certifications** section and add any certifications that you have received.