



Blue Flame™
Black Flame™

Models: L60111 & L60222



PLEASE READ:

Before throwing with Flame Pitching Machine please read and follow all safety labels and WARNINGS located on the Machine.

The package contents are shown to the right.

Tools required for assembly:

- 2 - 9/16" wrenches
- 1- Phillips screwdriver

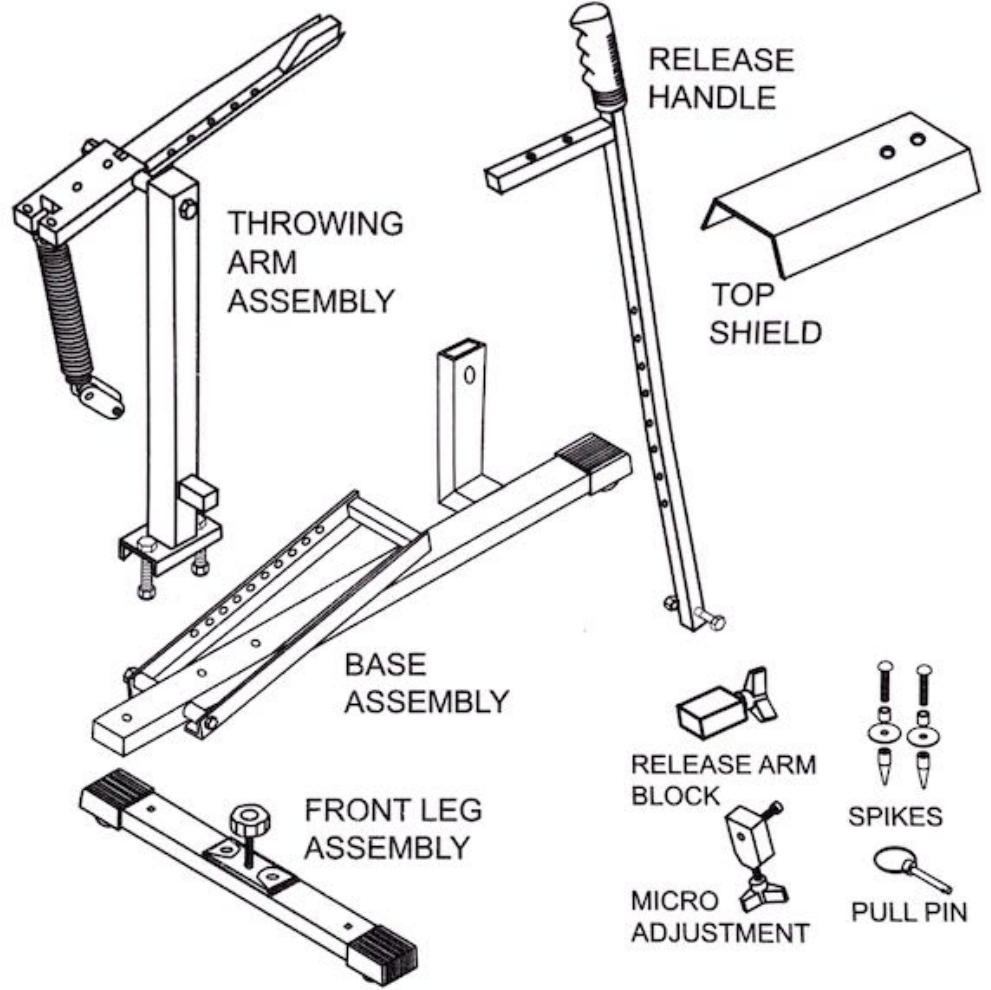

ASSEMBLY

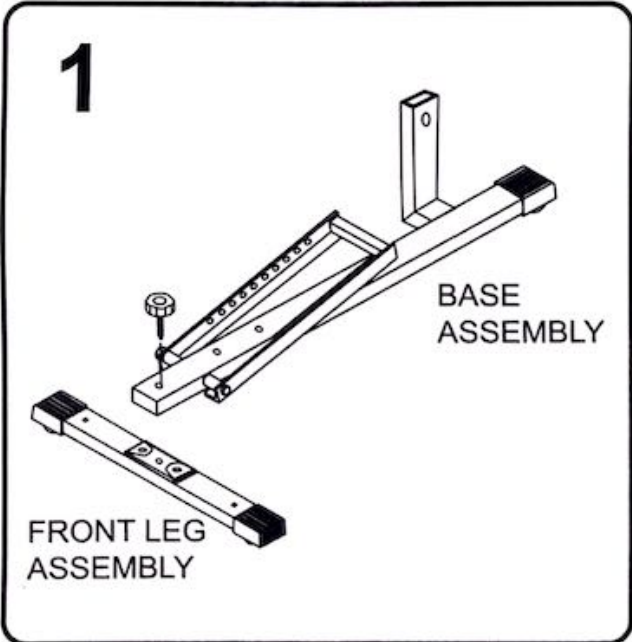

1) Most hardware needed is pre-attached and will only need to be removed and reattached as the instructions indicate.

Remove the large knob from the FRONT LEG ASSEMBLY. Align the BASE ASSEMBLY to the FRONT LEG ASSEMBLY and reattach knob. Tighten securely.

2

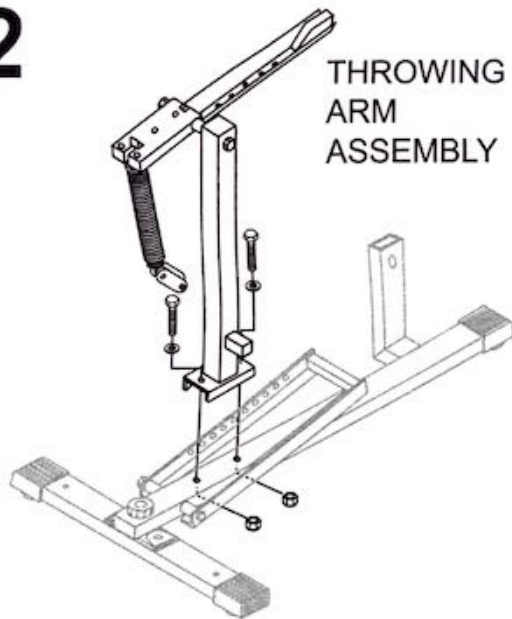

THROWING
ARM
ASSEMBLY

2) Remove the nut, bolt and washers from the THROWING ARM ASSEMBLY shown in diagram 2 with two 9/16" wrenches. Align the THROWING ARM ASSEMBLY to the BASE ASSEMBLY. Attach the two bolts and washers and tighten. (The bottom plate on the BASE ASSEMBLY is threaded). After the THROWING ARM is tightened to the BASE ASSEMBLY reattach the nuts and tighten securely.

3

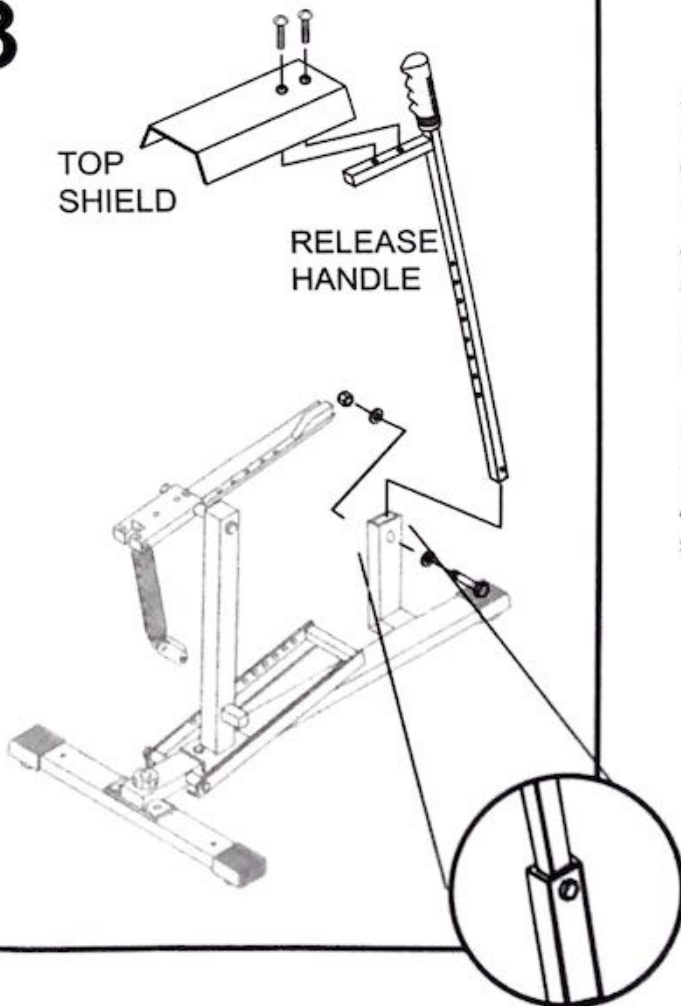

TOP
SHIELD

RELEASE
HANDLE

3) Remove the nut, bolt and two washers from the BASE ASSEMBLY shown in diagram 3 with two 9/16" wrenches. Insert RELEASE HANDLE into the upright tube in the BASE ASSEMBLY. Insert bolt and washer and attach washer and nut. Tighten securely, **DO NOT OVERTIGHTEN**. The RELEASE HANDLE should move freely but not have side to side movement.

Remove the two screws from the top of the RELEASE HANDLE with a phillips screwdriver. Attach the TOP SHIELD and secure with the two screws.

ASSEMBLED VIEW

4

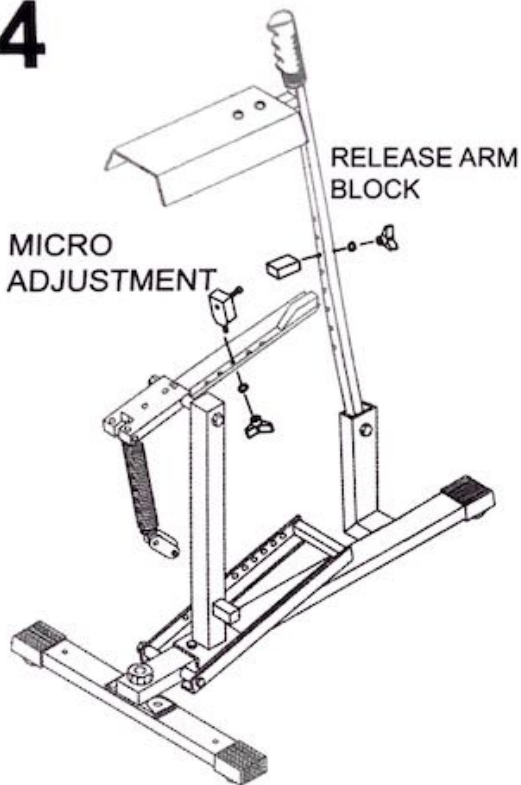

4) Attach the MICRO ADJUSTMENT and the RELEASE ARM BLOCK into the numbered hole based on the desired speed shown on the chart located on the TOP SHIELD of your machine.

5

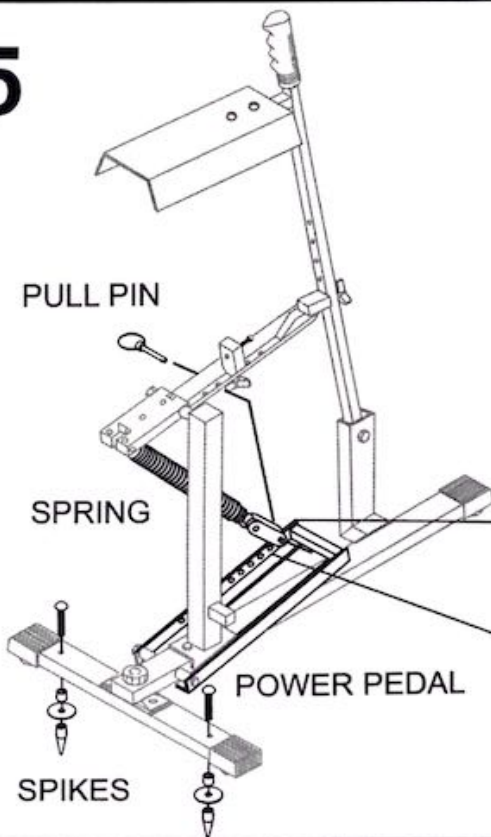

5) Attach the optional SPIKES to the FRONT LEG ASSEMBLY.

FINAL STEP: Attach the SPRING to the numbered hole on the POWER PEDAL for the desired speed based on the speed chart on the top shield. To extend the life of the spring detach the SPRING from the POWER PEDAL when not in use.

